

SUBARU Rear Diff Info

LSD's – KAAZ / CUSCO

R180 diff is same size DBF2040.

R160 diff is same size DBF2035 and DBF2050

DBF2040 is for mechanical type LSD

DBF2035 is for Viscous LSD

DBF2050 is for Suretrack LSD

DBF2035 differ from DBF2050 in the position of a C- ring.

(Spring clip to lock in driveshaft - 2035 is approx. 40mm one side, approx.50mm other side. 2050 is approx. 50mm each side)

DBF2040 C-ring is what position?

Maybe USA model has open diff, so need to exchange parts.

Exchange part is STD driveshaft for viscous LSD.

I think that you will understand what kinds of KAAZ LSD suit,
if you research std diff in European market.

DBF2040 is confirmed to WRX STi VerIII/IV/V/VI

WRX-RA STi VerIII/IV/V/VI (standard Diff: mechanical plated type)

DBF2050 is confirmed to WRX STi VerV/VI

WRX-RA STi Ver V/VI (standard Diff: Suretrac)

These two LSDs are different re the size of the clutch plates and the spline of the side shafts.

DBF2040 --- teeth 27

DBF2050 --- teeth 25

To confirm there are two types of Impreza Rear diff R160 & R180

Here is how to distinguish between them externally

The alloy back plate on every Impreza diff has 2 studs that stick out. These studs locate in to bushes on the sub frame.

1. R160 diff: each of these studs will have its own square cast Section at the bottom of them (as can be seen circled in red on the below picture).
2. R160 diff: the alloy back plate of this unit measures 155mm across

1. R180 diff: the studs will be set into one long rectangular section instead of separate ones like the R160
2. R180 diff: the alloy back plate of this unit measures 168mm across.
3. R180 diff: this case can contain either a 'mechanical' LSD or a 'suretrac' unit to make 100% sure what your car has pull out a rear drive shaft and count the splines a 'suretrac' has 25 a 'mechanical' has 27.

The R180 type diff is fitted to the following vehicles (From Cusco catalogue, so relates to JDM models – US & EU versions can vary) all other versions use R160

GC8 sti V3	96-97	Mechanical version		
GC8 sti V4	98-99	“	“	“
GC8 sti V5/6	99-00	“	“	“
GDB sti WRX.ra	00>	“	“	“
GDB sti WRX.ra	01>	“	“	“ (spec C)
GDB STI	00>	“	“	“
GGB wagon	00>	“	“	“
GRB sti WRX	07>	“	“	“

The KAAZ LSD for the mechanical version is DBF2040.
The Cusco number is LSD 182

GC8 WRX-RA	98-00	Suretrac version		
GF8 wagon	98-00	“	“	“
GDA (A/b)	00>	“	“	“
GGA wagon	00>	“	“	“
SF5	98-02	“	“	“

BH5, BE5 98-03 “ “ “
BP5 BL5 03 “ “ “

The KAAZ LSD for the SureTrac version is DBF2050.
The Cusco number is LSD 183



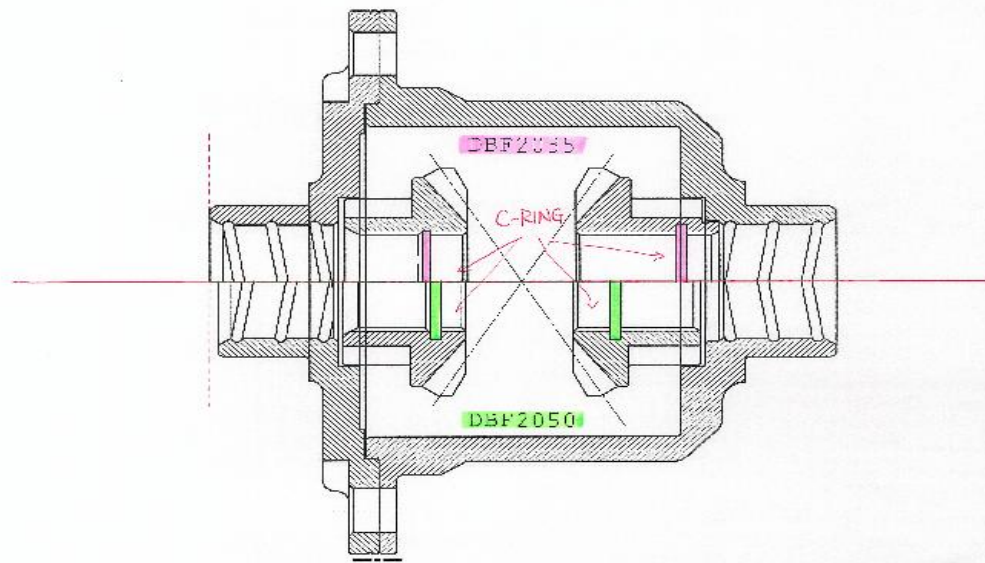

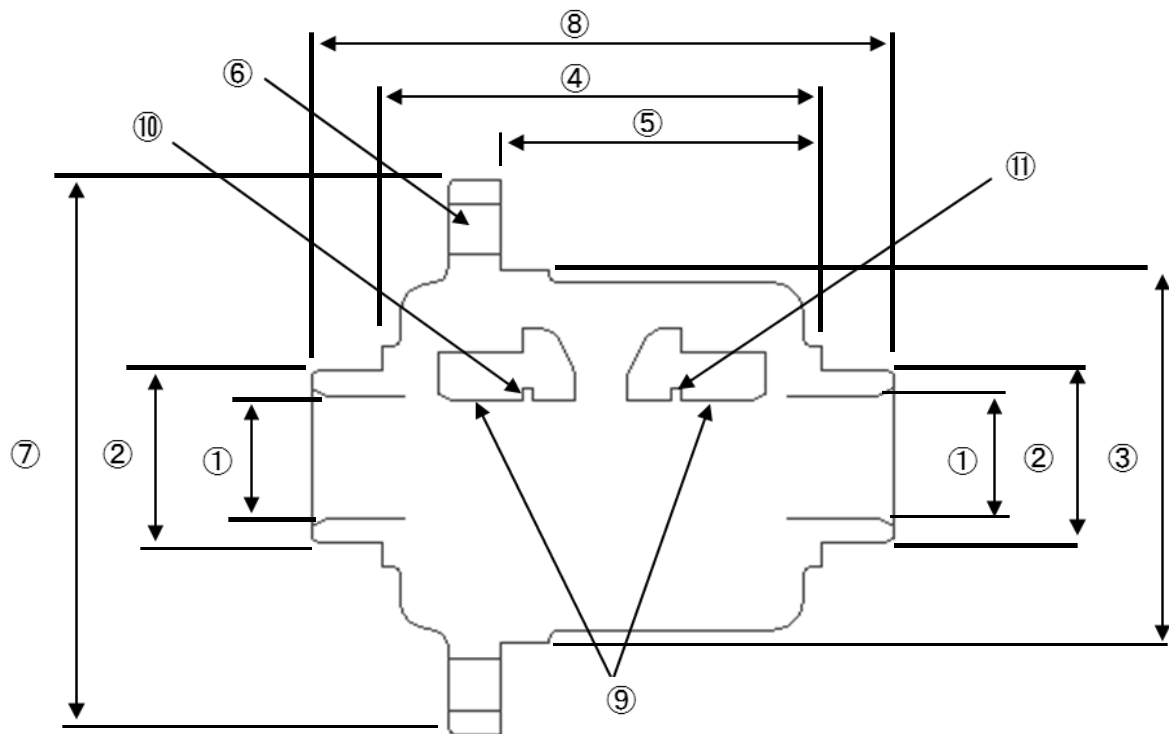

品番	モデル	① シャフト挿入部 内径	② ベアリング 圧入部外径	③ リングギヤ 取付部外径	④ ベアリング スパン	⑤ リングギヤ面	⑥ リングギヤ 取付ホル径	⑦ 最外径	⑧ 高さ	⑨ スプライン 枚数	⑩ サイドギヤ Cリング	⑪ サイドギヤ Cリング	備考
LSD 181	GC8 リヤ	φ 30	φ 40	φ 102	100	80	φ 11×8	φ 143	142	25T	無	有	
LSD 182	STI リヤ	φ 30	φ 40	φ 115	115	92.5	φ 11×8	φ 155	149	27T	有	有	
LSD 183	シュアトラック	LSD 181 ケース								25T	有	有	
LSD 684	BP5 リヤ	φ 30	φ 40	φ 102	106	92.5	φ 10×12	φ 143	146	25T	有	有	

